

Dimension: (UNIT:mm)

A	44.0+1.0
B	15.2-0.6
C	22.5-0.4
D	16.5 ± 0.4
E	32.5Min
F	15.2-0.6
G	
H	

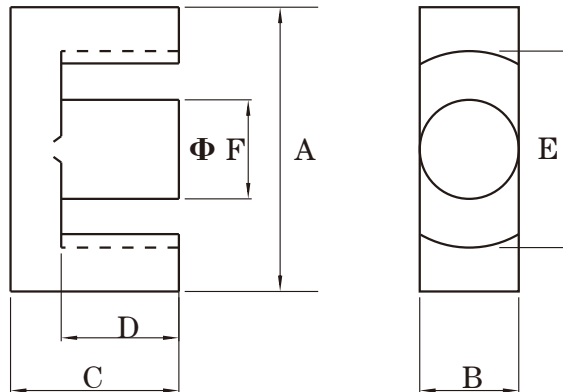

Test conditions

AL: F=1.0KHz U=0.3V N=10Ts

Effective parameter

C1(mm) ⁻¹	Ae(mm ²)	Le(mm)	Ve(mm ³)	Weight(g)
0.589	173	103	17800	≈47

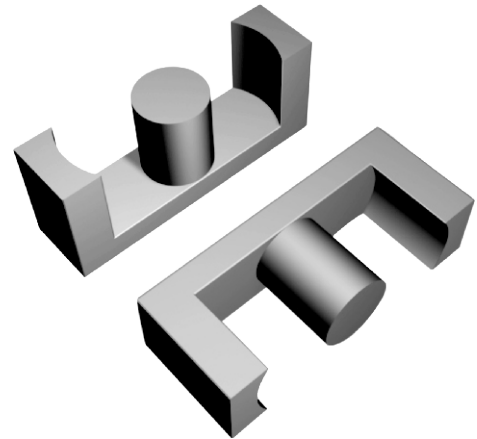

Core halves.

Clamping force for Al measurements, 40+/-20N.
gapped cores are available on request.

Grade	AL (nH)	μe	AIR GAP μm	Type number
P3	3800 ± 25%	≈ 1800	≈ 0	ETD44-P3
P4	3800 ± 25%	≈ 1800	≈ 0	ETD44-P4
HQ2K	3500 ± 25%	≈ 1660	≈ 0	ETD44-HQ2K

Properties of core sets under power conditions

Grade	B (mT) at		Core loss (w) at		
	H=250 A/m F=25KHz T=100°C	F=25 KHz B=200mT T=100°C	f=100 KHz B=100mT T=100°C	F=100 KHz B=200 mT T=100°C	F=400 KHz B=50mT T=100°C
P3	≥330	≤2.2	≤2.3	-	-
P4	≥330	-	≤1.7	≤9.4	-
HQ2K	≥320	-	≤2.2	-	≤3.9

Note:

- 1: Document is the property of FUAN Inc & is not allow to be duplicated without authorization
- 2: RoHS compliant.